

# Add a Patient's Address to the Appointment Window on the iPad

07/24/2024 11:59 am EDT

We have created a way to allow providers to see a glance to identify the address of a patient in the Appointment Detail View. You can enable this feature on the iPad by following the steps below.

## 1. Tap More option in the bottom toolbar and select Account Settings.

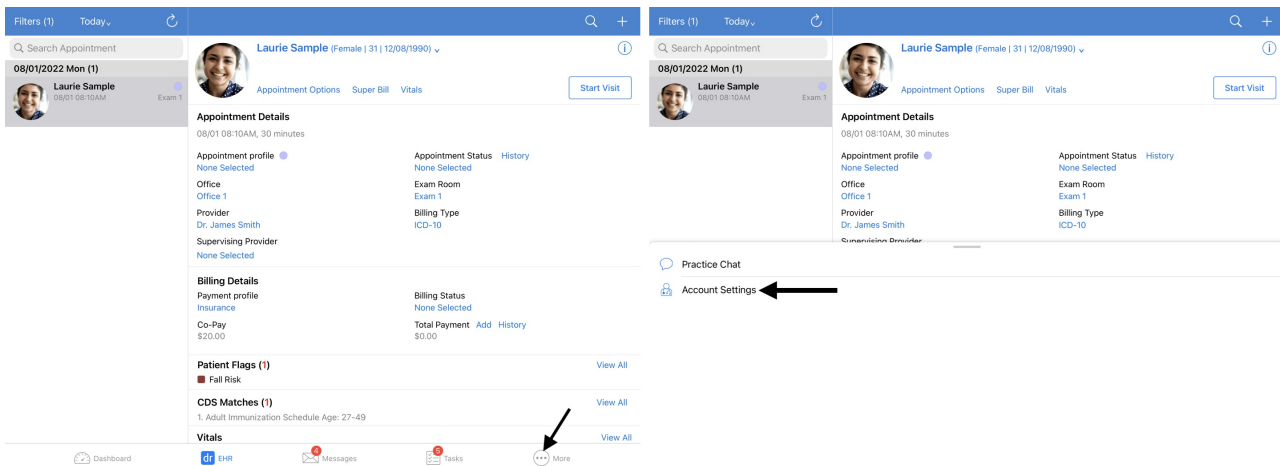

## 2. Select Appointment Detail View Settings.

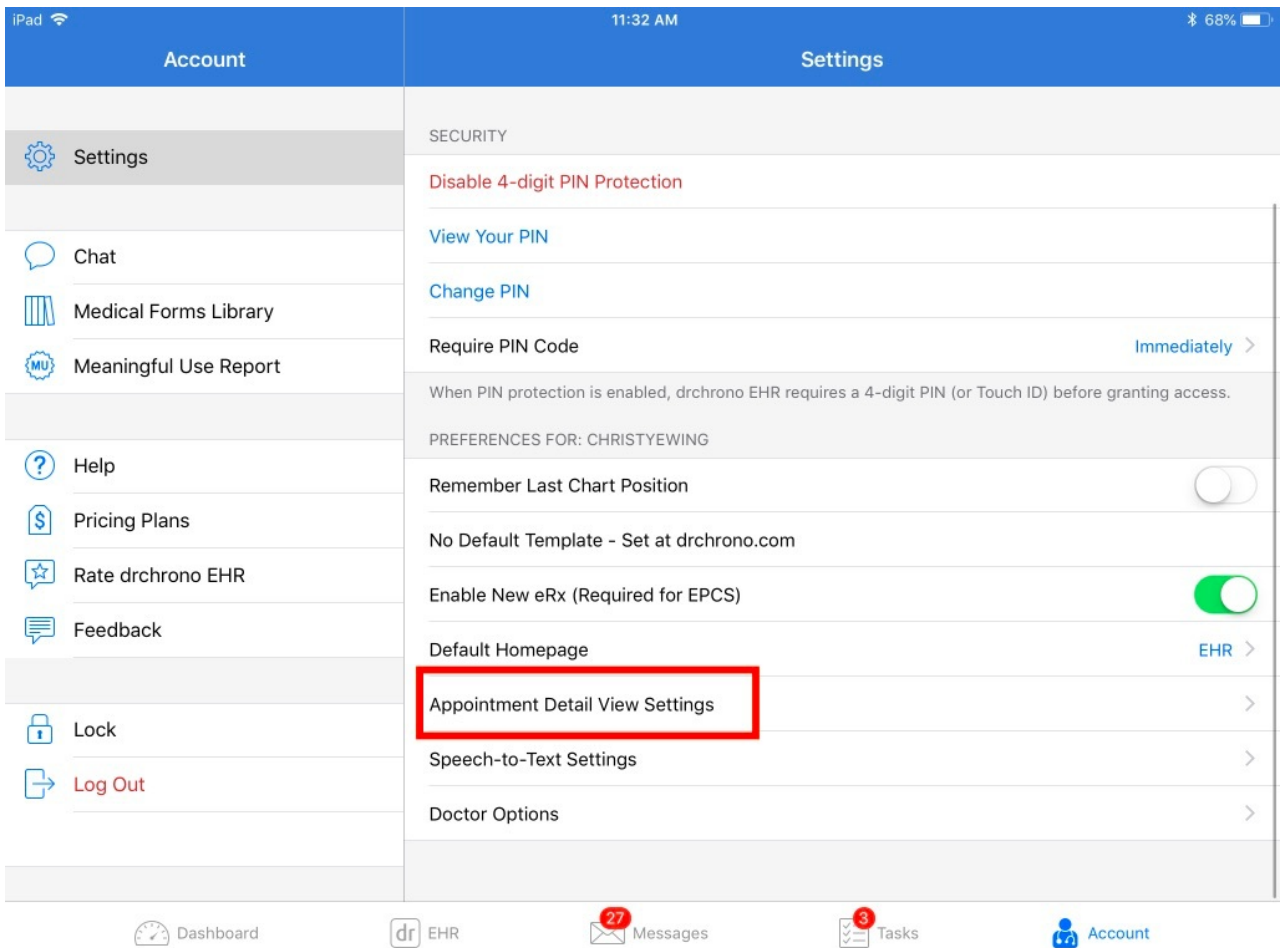

3. Find **Patient Address** and turn the switch to green to enable this feature.

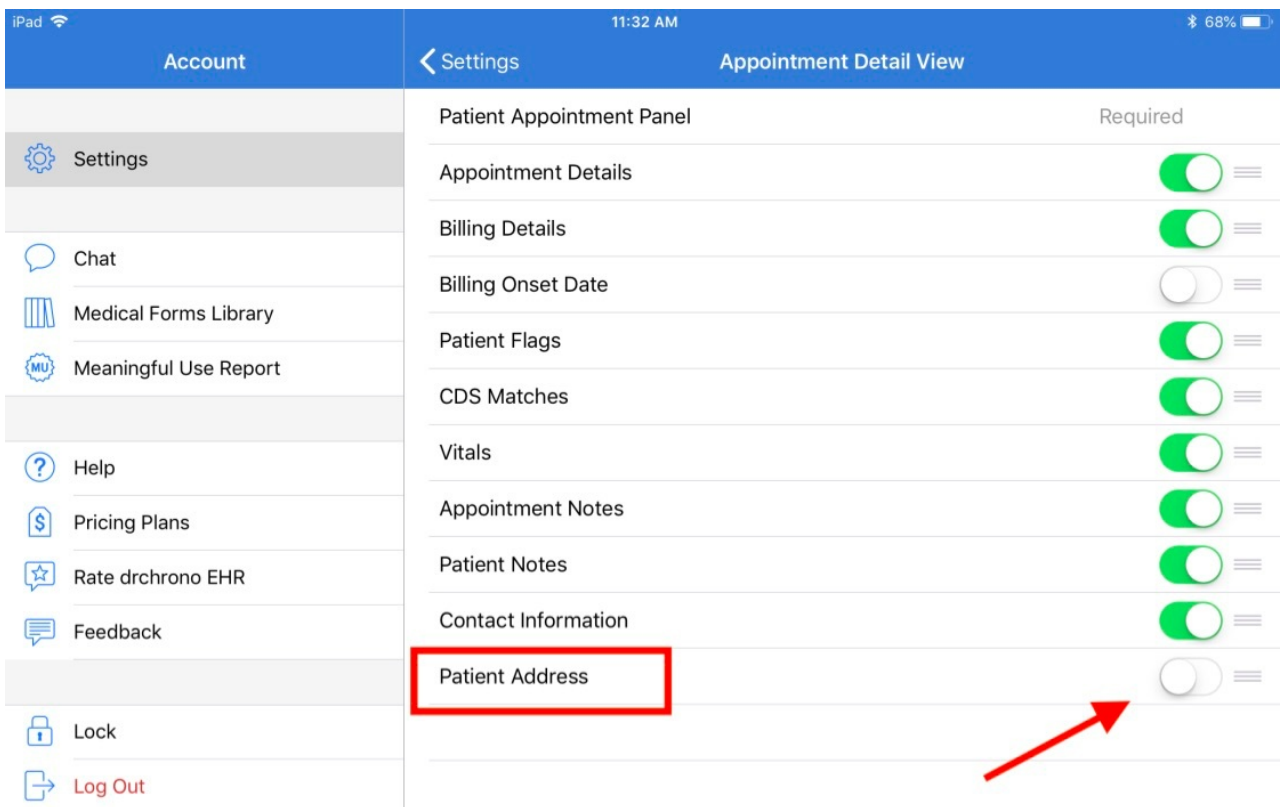

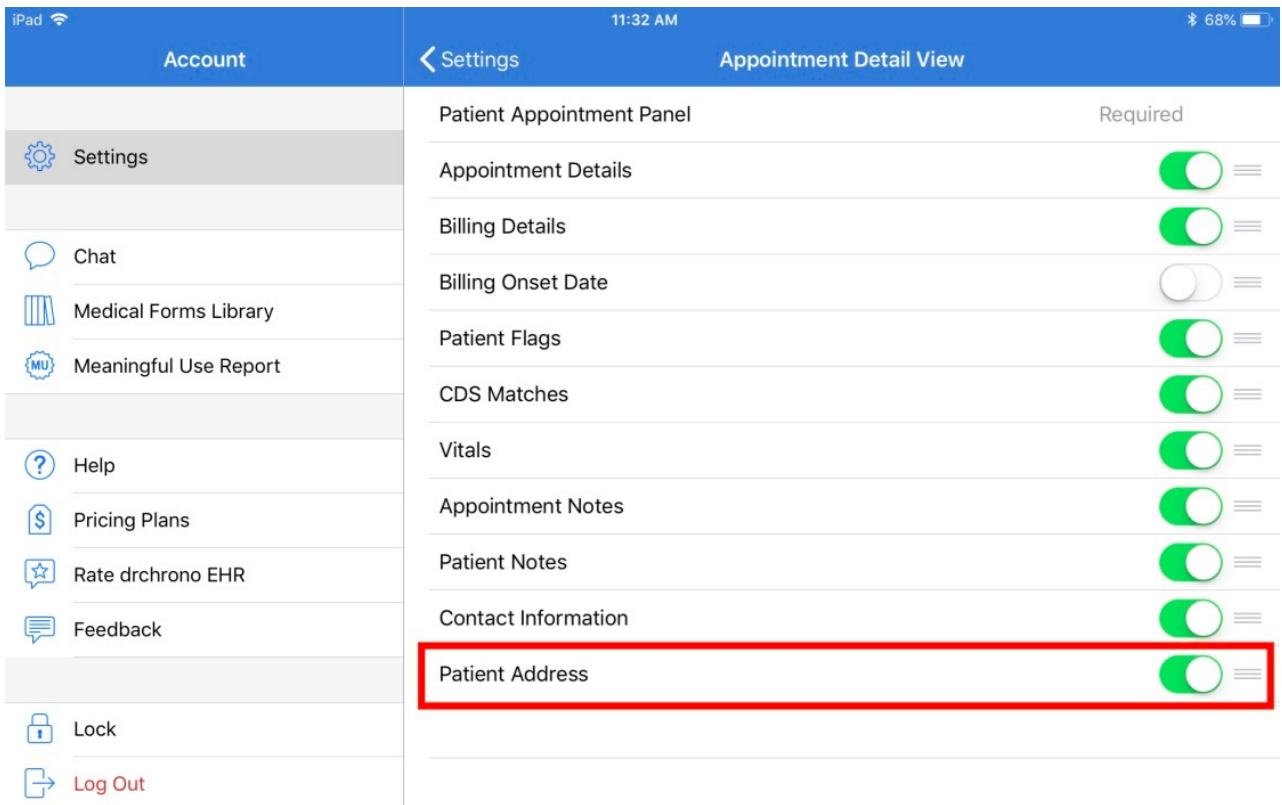

If you would like the Patient Address section to be viewed at the top of the appointment window, press and hold down the three stacked lines (



) and drag it to the top. This will allow you to view the patient's address at the top of the appointment window screen instead of scrolling through the appointment window to find it.

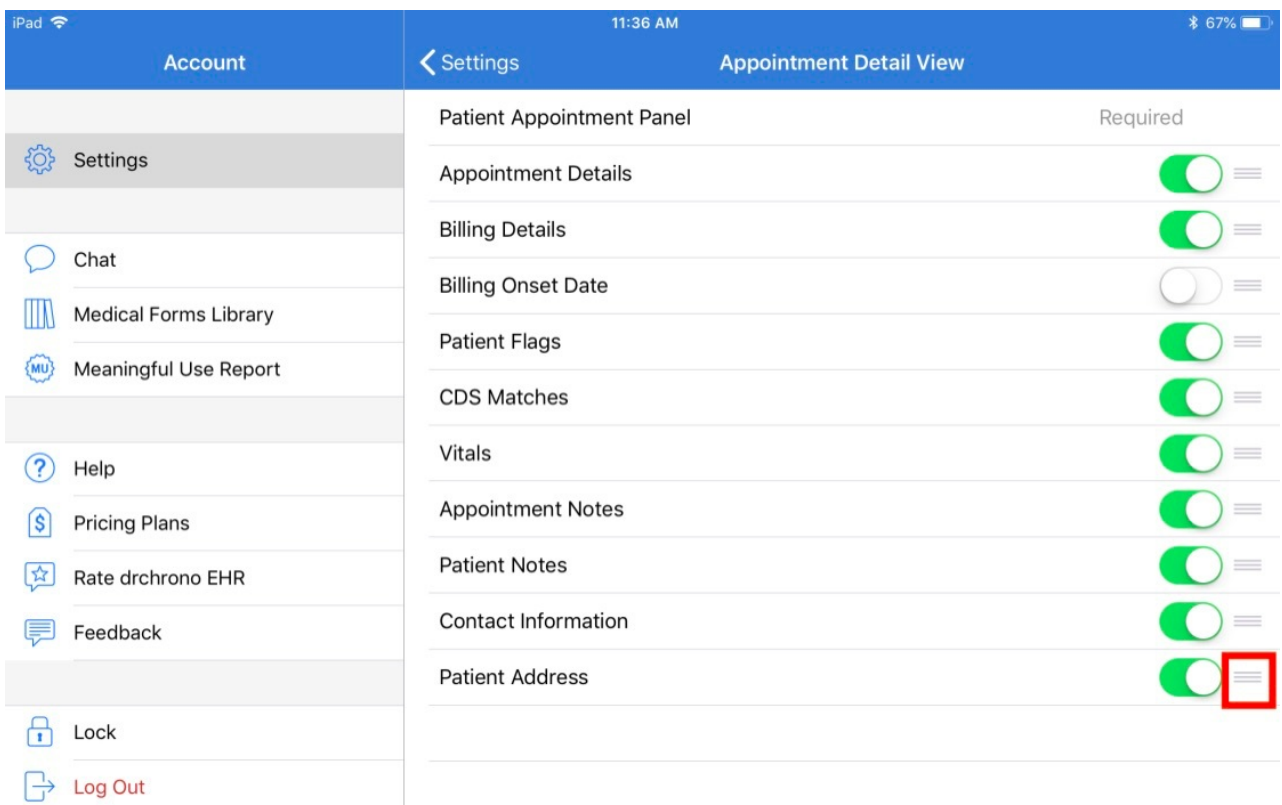

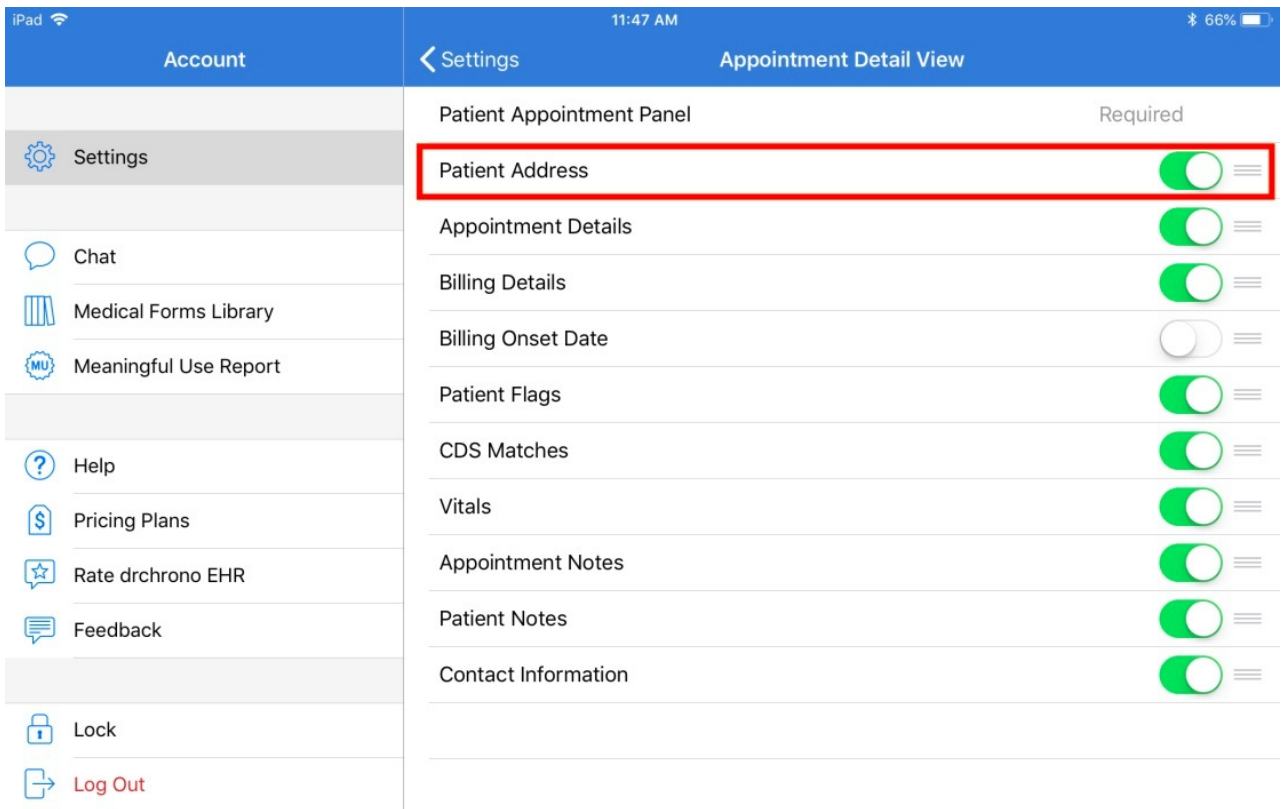
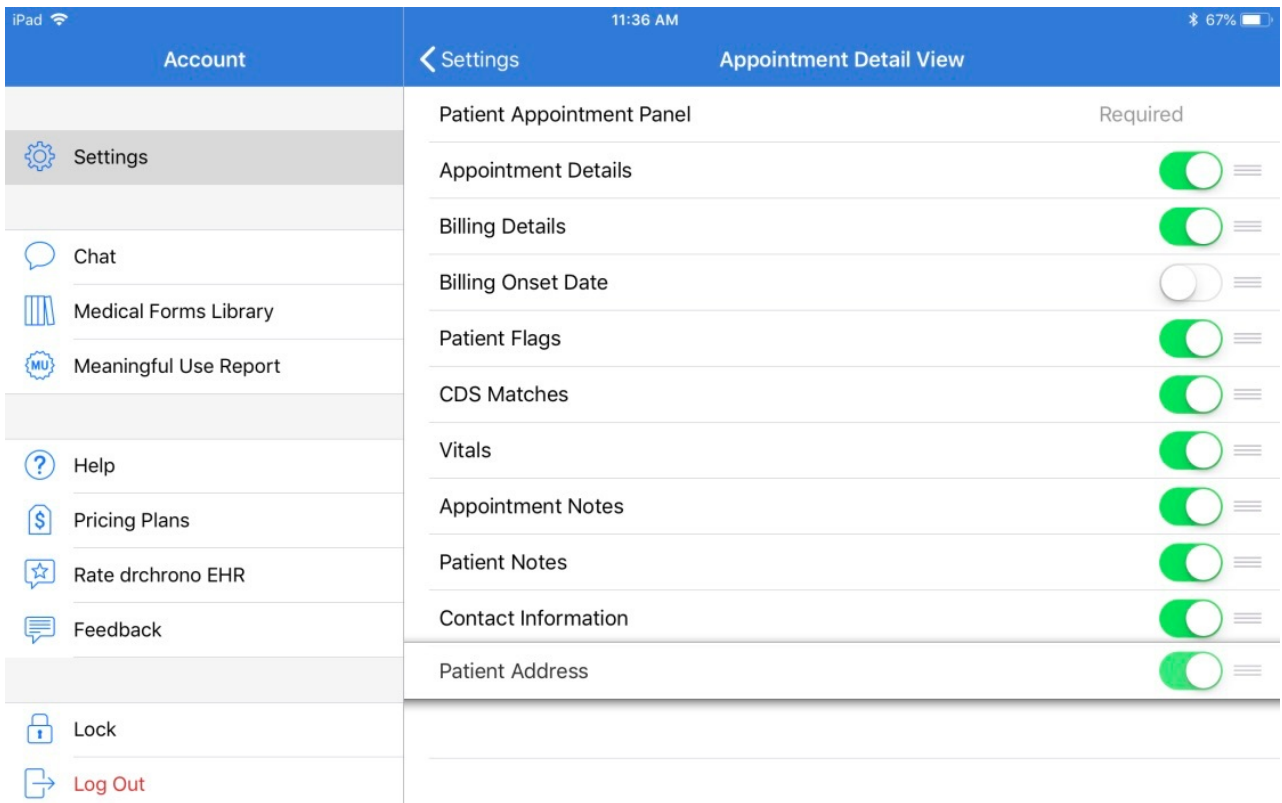

Select an appointment, you will now be able to view the patient's address at the top of the appointment window.

iPad 11:37 AM 67%

Filters 08/21/18

Search Appointment

08/21/2018 Tue

Jenny Harris 08/21 12:00PM Exam 1

Peter Django 08/21 01:00PM Exam 1

Michelle Harris 08/21 01:30PM Exam 1

Chris Genning 08/21 02:30PM Exam 1

Jenny Harris (Female | 38 | 02/11/1980)

This is a sample patient. To turn off sample patients, go to the Account tab.

Appointment Options Super Bill Vitals Start Visit

2 Castro Street, Mountain View, CA 94040

Appointment Details

08/21 12:00PM

Appointment profile None Selected

Office Primary Office

Provider Christy Ewing

Appointment Status None Selected

Exam Room Exam 1

Billing Type ICD-10

Billing Details

Payment profile Cash

Co-Pay \$20.00

Billing Status None Selected

Total Payment Add Receipt \$0.00

Patient Flags (1) View All

Handle with Care

CDS Matches (5) View All

1. All patients with diabetes should have a glycohemoglobin blood test within the past 6 months.

Dashboard dr EHR Messages 27 Tasks 3 Account

If the address is valid, it will allow you to tap on it and open that address in the Apple Maps app. You can also press and hold the address to generate a drop-down menu giving you the ability to choose which action you would like to take.

iPad 11:37 AM 67%

Filters 08/21/18

Search Appointment

08/21/2018 Tue

Jenny Harris 08/21 12:00PM Exam 1

Peter Django 08/21 01:00PM Exam 1

Michelle Harris 08/21 01:30PM Exam 1

Chris Genning 08/21 02:30PM Exam 1

Jenny Harris (Female | 38 | 02/11/1980)

This is a sample patient. To turn off sample patients, go to the Account tab.

Appointment Options Super Bill Vitals Start Visit

2 Castro Street, Mountain View, CA 94040

2 Castro Street, Mountain View, CA 94040

Get Directions

Open in Maps

Add to Contacts

Copy Address

Appointment Status History None Selected

Exam Room Exam 1

Billing Type ICD-10

Payment profile Cash

Co-Pay \$20.00

Billing Status None Selected

Total Payment Add Receipt \$0.00

Patient Flags (1) View All

Handle with Care

CDS Matches (5) View All

1. All patients with diabetes should have a glycohemoglobin blood test within the past 6 months.

Dashboard

dr EHR

27 Messages

3 Tasks

Account

